

Hunter 4MP WiFi Floodlight Camera

Active Alarm with Built-in Siren and Floodlights



- 1/3-in. 4MP Progressive-scan CMOS Sensor
- 4MP (2560 x 1440) at 30 fps, 2.8 mm Fixed Lens
- 2.4 or 5 GHz Wifi Options, IEEE802.11a/b/g/n/ac
- Smart H.265+ and Smart H.264+ Dual Codecs
- Maximum Resolution of 4MP at 30 fps
- Active Alarm with Integrated 110 dB Siren and Floodlight
- Built-in Microphone and Speaker
- IP65 Ingress Protection



System Overview

The Galaxy Hunter Series includes the IPC-L46N, a floodlight camera with a 4MP CMOS sensor, 2.8 mm fixed lens, and two powerful 2400 Lumen floodlights to provide illuminate the property and deter any prospective attackers. The camera is equipped with Galaxy's Analytics+ which focuses on human and vehicle targets to reduce false warnings. You can converse with visitors or intruders on your property using the camera's two-way audio through the DMSS mobile app.

Functions

Smart H.264+ and Smart H.265+

Delivering high quality video without straining the network, Smart H.264+ is the optimized implementation of H.264. The Smart H.264+ encoding platform includes a scene adaptive encoding strategy, dynamic GOP, dynamic ROI, flexible multi-frame reference structure and intelligent noise reduction, providing a savings of up to 70% of bandwidth and storage when compared with standard H.264.

Smart H.265+ is the optimized implementation of the H.265 codec that uses a scene-adaptive encoding strategy, dynamic GOP, dynamic ROI, flexible multi-frame reference structure and intelligent noise reduction to deliver high-quality video without straining the network. Smart H.265+ technology reduces bit rate and storage requirements by up to 70% when compared to standard H.265 video compression.

Smart Dual Illumination

The camera offers both IR and white-light illuminators and intelligently employs each depending on the situation. Typically, the camera enters the IR mode as ambient light decreases. When the camera detects an object entering the monitoring area, it activates the white-light illuminator to capture full-color details. Once the object leaves the area, the camera switches back to IR illumination.

Day/Night

A day/night mechanical IR cut filter makes this camera ideal for applications with fluctuating lighting conditions, delivering color images during the day and automatically switching to monochrome as the scene darkens.

Cybersecurity

Galaxy network cameras are equipped with a series of key cybersecurity technologies including: security authentication and authorization, access control, trusted protection, encrypted transmission, and encrypted storage. These technologies improve the camera's ability to prevent malicious access and to protect data

Technical Specification				
Camera				
Image Sensor		1/3-in. 4MP CMOS		
Effective Pixels		2560 (H) × 1440 (V)		
RAM/ROM		512 MB/128 MB		
Electronic Shutter Speed		1/3 s to 1/100,000 s		
S/N Ratio		> 56 dB		
Minimum Illumination		Color (30 IRE): 0.005 Lux at F1.6 B/W (30 IRE): 0.0005 Lux at F1.6 IR (Illuminator On): 0 lux		
Illuminators		One (1) IR LED Two (2) Floodlights		
Illuminator On/Off Control		Auto, Manual		
Illumination Distance		IR: 10 m (32.81 ft) Floodlight: 30 m (98.43 ft)		
Floodlight Brightness		1500 to 2400 lm		
Floodlight Color Temperature		Warm: 3000K±200K Cool: 6000K±300K		
Floodlight Modes		Motion Activation Manual Schedule PIR Activation		
Pan/Tilt/Rotation Range	Camera	Pan: −85° to 85° Tilt: −90° to 45° Rotation: 0° to 360°		
	Floodlight	Tilt: −90° to 90° Rotation: −145° to 145°		
PIR Sensor Distance¹		10.0 m (32.81 ft)		
PIR Detection Range		270°		
Lens				
Lens Type		Fixed		
Lens Mount		M12		
Focal Length		2.8 mm		
Maximum Aperture		F1.6		
Field of View	Horizontal	98°		
	Vertical	55°		
	Diagonal	115°		
Iris Type		Fixed		
Close Focus Distance		1.0 m (3.28 ft)		
DORI² Distance		Detect	Observe	Recognize
		61.2 m (200.79 ft)	24.5 m (80.38 ft)	12.2 m (40.03 ft)
				Identify
				6.1 m (20.01 ft)
Video				
Compression		Smart H.265+, H.265, Smart H.264+, H.264, H.264H, H.264B, MJPEG		
Streaming Capability		Three (3) Streams		
Resolution		4MP (2560 × 1440), 3MP (2304 × 1296), 1080p (1920 × 1080), 1.3MP (1280 × 960), 720P (1280 × 720), D1 (704 × 480), VGA (640 × 480), CIF (352 × 240)		
Frame Rate	Main Stream	2560 × 1440 at 30 fps		
	Sub Stream 1	704 × 480 at 30 fps		
	Sub Stream 2	640 × 480 at 30 fps		
Bit Rate Control		CBR/VBR		
Video Bit Rate		H264: 32 kbps to 8192 kbps H265: 32 kbps to 8192 kbps		
Day/Night		Auto, Color, B/W		
Backlight Compensation		BLC, HLC, DWDR		
White Balance		Auto, Natural, Street Lamp, Outdoor, Manual, Regional Custom		
Gain Control		Auto, Gain Priority, Shutter Priority, Manual		

Image Rotation	0°, 90°, 180°, 270°
Image Mirroring	Supported
Noise Reduction	3DNR
Motion Detection	Off/On (4 Areas, Rectangular)
Region of Interest (RoI)	4 Areas
Privacy Masking	4 Areas
Advanced Features	Smart Illumination

Audio

Built-in Microphone	Yes
Built-in Speaker	Yes
Compression	G.711a, G.711Mu, G.726, PCM

Network

WiFi	IEEE802.11a/b/g/n/ac 2.4–2.4835 GHz and 5.18–5.85 GHz
Protocol	IPv4, IPv6, ARP and Ping, TCP, UDP, HTTP, RTSP, HTTPS, DDNS, Email, SNMP, Multicast, Auto Registration, Wireless Qos, Wi-Fi Setting, Hotspot Scanning, 802.1x, UPnP Status, Bonjour, UPnP, Device Discovery
Interoperability	ONVIF, CGI, P2P, RTMP, SDK, API
Maximum User Access	6 Users (Total Bandwidth: 36 Mbps)
Edge Storage	FTP, SFTP, MicroSD Card (Maximum 256 GB), NAS
Web Viewer	Microsoft Edge, Chrome, Firefox
Management Software	DMSS
Mobile Operating System	Android, iOS
Cybersecurity	Video Encryption, Configuration Encryption, Digest, WSSE, Account Lockout, Security Logs, Generating/Importing X.509 certification, HTTPS, Trusted Boot, Trusted Execution, Trusted Upgrade

Alarm

Event	No SD Card, SD Card Full, SD Card Error, Network Disconnection, IP Conflict, Illegal Access, Security Exception, Motion Detection, Video Tampering, Sence Changing, SMD (Human, Animal, Vehicle), Audio Detection, Intensity Change
-------	---

Electrical

Power Supply	100 to 240 VAC
Power Consumption	Basic: 5.2 W (100–240 VAC) Maximum (Illuminator+IPC): 48.3 W (100–240 VAC)

Environmental

Operating Temperature	−20 °C to +50 °C (−4 °F to +122 °F)
Operating Humidity	≤ 95%
Storage Temperature	−20 °C to +50 °C (−4 °F to +122 °F)
Protection	IP65

Structure

Casing	Metal, Plastic
Product Dimensions (L x W x H)	270.7 mm × 217.2 mm × 195.6 mm (10.66 in. × 8.55 in. × 7.70 in.)
Net Weight	1.40 kg (3.09 lb)
Gross Weight	1.88 kg (4.14 lb)

Certifications

Safety	EN62368-1
Electromagnetic Comptability (EMC)	Electromagnetic Compatibility Directive 2014/30/EU Radio Equipment Directive 2014/53/EU 47 CFR FCC Part 15, Subpart B

Intelligent Video System

IVS triggers an alarm and takes a defined action for the following events:	
Standard Features	<ul style="list-style-type: none">Tampering with the camera.Error writing to an onboard Micro SD card.Error sending or receiving data over the network.Unauthorized access to the camera.
Premium Features	
Motion	An object moves through any part of the scene.
Intrusion	A target enters or exits a defined perimeter.

Ordering Information

Type	Model	Description
Floodlight Camera	IPC-L46N-USA	4MP Floodlight Camera with 32GB MicroSD Card (US Only)
	IPC-L46N-CAN	4MP Floodlight Camera with 32GB MicroSD Card (Canada Only)

Installation

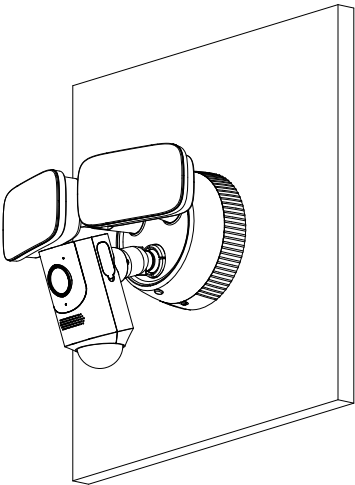

Dimensions

mm [inch]

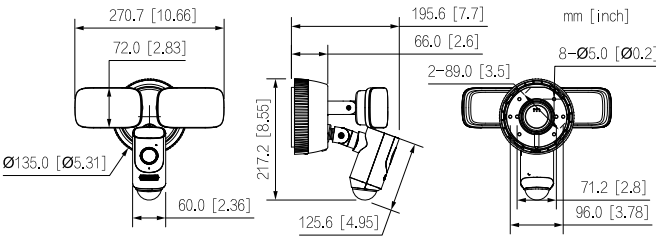

1. The height of the device is 3 m and placed at a 30° angle from the horizontal.
2. The DORI distance is a measure of the general proximity for a specific classification to help pinpoint the right camera for your needs. The DORI distance is calculated based on sensor specifications and lab test results according to EN 62676-4, the standard that defines the criteria for the Detect, Observe, Recognize and Identify classifications.
3. The values above are the max. frame rates of each stream; for multiple streams, the values will be subjected to the total encoding capacity.